



# DC Current Transducer

DIN RAIL / PANEL MOUNT

The **CR5200** Series, DC Current Transducers are designed to provide a DC signal which is proportional to a DC sensed current. These devices are designed for direct current only, targeting them towards general and daily applications. The ranges 2 to 10 Amp utilize an advanced Magnetic Modulator technology and the ranges 20 amps and above utilize Hall Effect technology.

## Applications

- Battery chargers and systems
- DC motor drives
- Power supply management
- Mobile applications

## Features

- Closed loop sensing for accuracy
- 35mm DIN rail or panel mount
- 0 - 5 Vdc or 4 - 20 mA DC outputs
- Non-contact DC current sensing
- Connection diagram printed on case



**CR5210    CR5220**  
.79" Window

**Internet Resources** <http://www.crmagnetics.com/>

Pricing: [pricing/5200.html](http://www.crmagnetics.com/pricing/5200.html)

See page 34 for typical applications

## Part Numbers

**CR5210** -  0- 5 Vdc output  
**CR5220** -  4 - 20 mA DC output

Add suffix for input range

<b>.79" Window</b>			<b>.79" Window</b>		
<b>2</b>	-	0-2 Adc	<b>20</b>	-	0-20 Adc
<b>5</b>	-	0-5 Adc	<b>30</b>	-	0-30 Adc
<b>10</b>	-	0-10 Adc	<b>50</b>	-	0-50 Adc
			<b>75</b>	-	0-75 Adc
			<b>100</b>	-	0-100 Adc
			<b>150</b>	-	0-150 Adc
			<b>300</b>	-	0-300 Adc

# DC Current Transducer

## Specifications

<p>Basic Accuracy:..... 1.0 %</p> <p>Thermal Drift:..... 500 PPM/°C</p> <p>Operating Temperature:..... 0°C to +50°C</p> <p>Response Time: ..... 250 ms. max.,0-90% FS</p> <p>Insulation Voltage:..... 2500 Vdc</p>	<p>Supply Voltage:..... 24 Vdc ±10%</p> <p>Frequency Range:..... DC only</p> <p>MTBF:..... Greater than 100 K hours</p> <p>Output Load:.....0-5 Vdc..... 2 K or greater</p> <p style="padding-left: 100px;">4-20 mA DC..... 0 - 300Ω</p>
--	--

## Connection Drawing

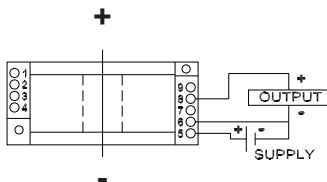

**CR5210**  
0 - 5 Vdc Output

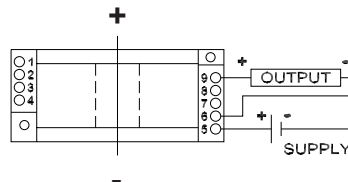

**CR5220**  
4 - 20 mA DC Output

## Outline Drawing

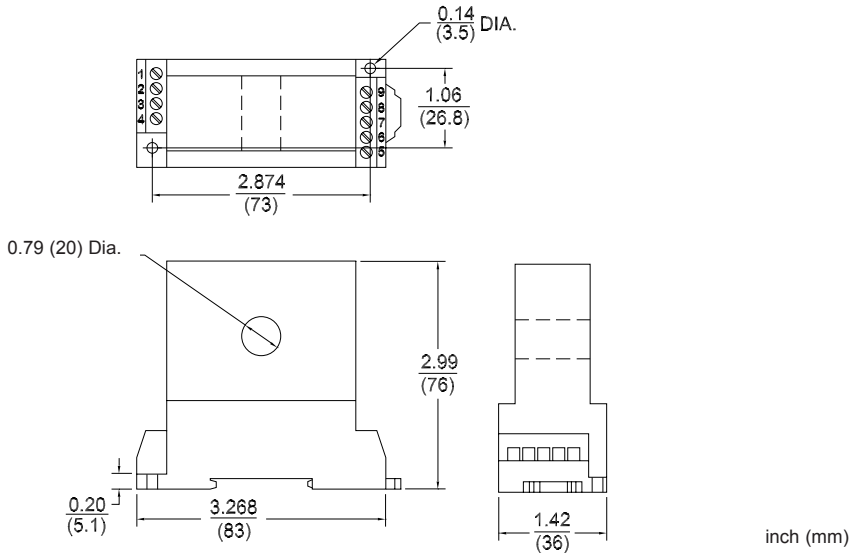

inch (mm)